

Cornered Ci4 and Ci4-V



Description

Ci4-V is a feature packed compact 2-way full-range speaker with medium output and full-range bass performance. The cabinet design is exceptionally discreet while offering great sound. With a wide and uniform dispersion, full coverage can be achieved by installing relatively few speakers, which makes the Ci4-V especially suited for in-door and outdoor commercial installations.

The patented triangular Cornered design ensures fast and easy installation. The integrated mounting points allows the cabinet to mount flush in corners or onto walls and ceilings without brackets. Or - for an even easier and more flexible installation - the cabinet can be mounted on two slider brackets. Cabinets can be coupled together to increase coverage to 180, 270 or 360 degree. The cable terminal is hidden behind the grille with the cable mounted from the rear of the cabinet, making the cable connection invisible both in vertical and horizontal applications.

The tweeter features a switchable protection circuit for added safety and the Ci4-V model can be run in either 8 ohm or 70/100 volt. In high-impedance mode, tap settings for 3,5 - 7,5 or 15 watt output is conveniently located on the front baffle.

Ci4-V is the perfect elegant speaker solution for back ground sound in commercial installations such as cafes, hotels and shops.

FEATURES

- 4" woofer + 4" passive woofer
- 1" silk dome tweeter
- Triangular ABS cabinet
- IP65 rated
- Switchable limiting circuit for tweeter
- Mounts without brackets or with hidden sliders
- Hidden cable connection
- Ci4: 8 ohm
- Ci4-V: Switchable 100/70V mode/8 ohm mode

COLOURS



DATA

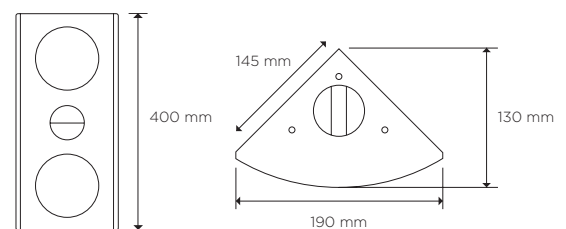

Power handling, IEC268:	60 watt
Power handling, peak:	240 watt
Sensitivity, 2.83V/1m:	86 dB
Maximum SPL, long term:	104 dB
Maximum SPL, peak:	110 dB
Frequency response:	60-20.000 Hz
Nominal impedance:	8 ohm
Dispersion:	100x100 degree
Measurements:	(HxWxD) 400x190x145mm
Weight:	2,7 kg (Ci4-V: 3,15 kg)

Cornered Ci4 and Ci4-V

Architectural Specifications

The loudspeaker system shall consist of a 4" woofer, a 4" passive woofer for extended bass performance and a 1" tweeter coupled to a wave guide with an even dispersion of nominal 100° by 100° degree. The tweeter shall be protected against damage from overpowering via a switchable limiting circuit that limits the power to the tweeter.

Specifications of a typical production shall be as follows: SPL at 1 m with 2.83 V input shall be at least 86 dB. Nominal impedance shall be 8 ohms, with minimum impedance being 7 ohm @240 Hz. Rated power handling according to IEC 268-5 shall be at least 60 watt. Frequency response shall be from 60-20kHz +/- 3 dB.

The enclosure shall be triangular in shape with no visible cable terminals and with a 90 degree angle allowing the speaker to be mounted flush in corners or onto wall and ceiling without brackets using the integrated mounting points or the integrated slider system. It shall be manufactured of ABS plastic with EN54 fireproof certification. The entire loudspeaker shall have IP65 outdoor rating. For theft deterrence, the installation points shall be hidden behind the grille. The input shall be switchable for use either at nominal 8 ohms, or on a 70V or 100V distributed speaker line via a built-in 15W transformer. Selectable taps shall allow operation at 7,5W, 15W from a 100V distributed speaker line, plus 3.75W, from a 70V line only. Speaker cable terminals shall be push terminals placed on the front baffle. Cabinet finish shall be white or black. Outside dimensions shall be no greater than 400mm (height) x 190mm (width) x 145mm (depth) and weight shall be 2,7 kg (Ci4-V: 3,15 kg). The loudspeaker system shall be the Cornered Audio Ci4-V (or Ci4 - without high impedance mode).

FREQUENCY RESPONSE

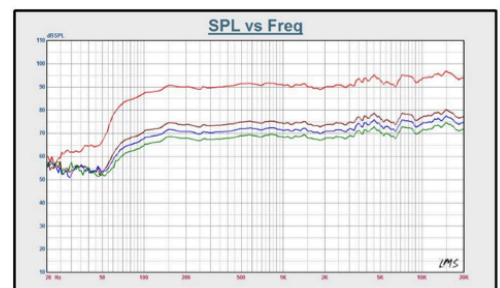

IMPEDANCE



CORNERED Audio ApS
Rosenkæret 13, 2. tv
2860 Søborg
Denmark

info@cornered.dk
+45 43 66 10 88
www.cornered.dk